

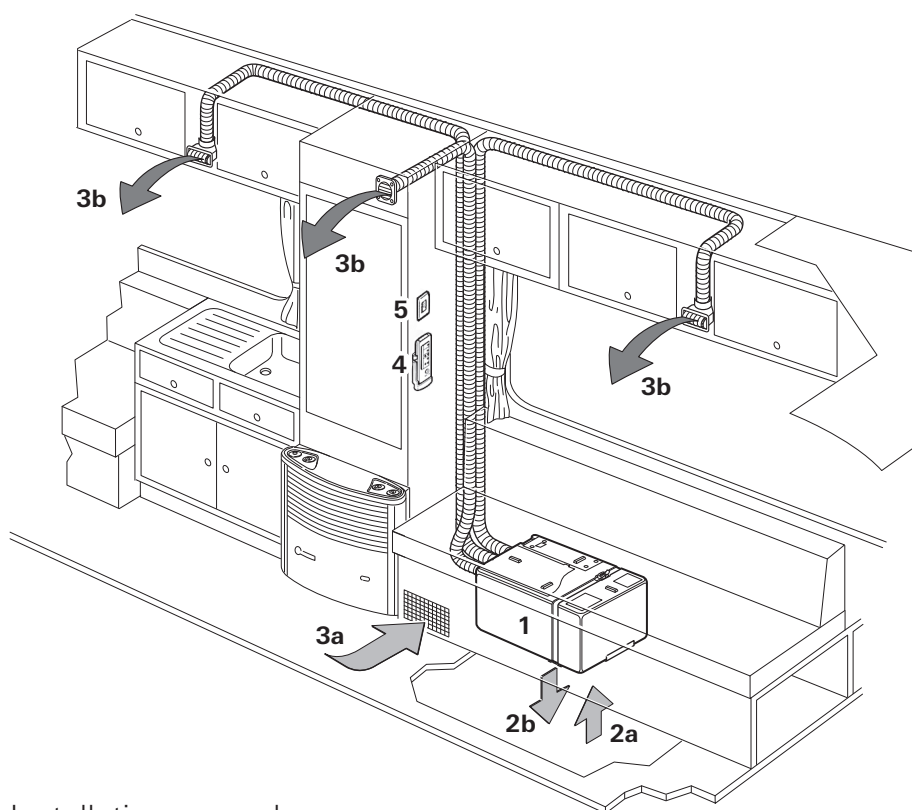

Saphir comfort RC (Australia)

AUS **Operating instructions**
Installation instructions
To be kept in the vehicle!

Page 2
Page 9



Installation example

- 1 Air conditioning unit Saphir comfort RC
- 2a Supply air intake
- 2b Supply air outlet
- 3a Circulatory air return
- 3b Air outlets
- 4 Infrared (IR) remote control
- 5 Infrared (IR) receiver

Table of contents

Symbols used	3
Safety instructions	3
Notes for the use of air conditioners	3

Operating instructions

Remote control	4
IR receiver and manual on / off	5
IR receiver / operating indicator	5
Red LED illuminates	5
Taking into operation	5
Switching on	5
Temperature	5
Mode	5
Fan	5
Sleep function	5
Switching off	5
Time	5
Timer ON / OFF	6
Reset	6
Resend	6
Setup	6
Maintenance	6
Troubleshooting	6
IR remote handset battery change	7
Disposal	7
Accessories	7
Technical data	7
Installation dimensions	8

Declaration of conformity	8
Truma warranty policy	8
Warranty conditions	8
Important notice	8
Warranty does not cover	8

Installation instructions

Scope of delivery	9
Intended use	9
Regulations	9
Choice of location	9
Installing the air conditioning system	9
Cold air distribution and circulating air return feed ...	10
Air distribution	10
Circulating air return	10
Installing the IR receiver	11

Symbols used



Installation and repair of the device may only be carried out by properly qualified professionals.



Symbol indicates a possible hazard.



Comment including information and tips.

Safety instructions



Repairs may only be carried out by properly qualified professionals!

In order to avoid transport damage, the unit may only be dispatched after consulting Domestic Service.

The voltage must be disconnected at all poles before the housing is opened.

The 230 V, T 6.3 A H-type (slow, IEC 127) fuse in the unit can be found on the electronic control unit and must always be replaced with an identical fuse.

Appliance fuses and connection leads may only be replaced by a properly qualified person.

Guarantee claims, warranty claims and acceptance of liability will be ruled out in the event of the following:

- modifications to the unit (including accessories),
- failure to use original Truma parts as replacement parts and accessories,
- failure to follow the installation and operating instructions.

It also becomes illegal to use the appliance, and in some countries this even makes it illegal to use the vehicle.

The refrigerant circuit contains R 407C refrigerant and must only be opened by an expert **in the factory**.

The air outlet and the circulating air intake must not be obstructed under any circumstances. Please bear this in mind in order to ensure the trouble-free operation of your device.

The apertures beneath the vehicle floor must be kept free of dirt and snow slush. The apertures must not be located within the area subject to spray from the wheels or mudguards. Splash protection must be provided if necessary.

If the floor of the vehicle is provided with **underfloor protection**, all the apertures beneath the vehicle must be covered in order to prevent the spray created from penetrating the device and causing malfunctions. Once the work has been completed the covers can be removed again.

In order to avoid damage to the compressor, when the device is in operation during transit (for example, with the generator or voltage transformer working), do not attempt uphill or downhill gradients of more than 8 %.

Do not allow cooling operation to run for extended periods in a tilted position, since the condensation water which forms may not be able to run off, and in the worst scenario might penetrate into the vehicle.

For problem-free operation and in order to avoid damage, the supply voltage must always come from a source with a sine wave curve (e.g. voltage converter, generator) and without voltage spikes.

When the floor of the vehicle is being cleaned, it must be ensured that no water penetrates the openings in the base of the unit when spraying with a high-pressure cleaner, for example.

For safety reasons, the unit may only be operated when it is closed, as only then is there a guarantee of protection against injury from moving parts. The strap on the electronics housing must not be removed.

Notes for the use of air conditioners

- The Saphir comfort RC air conditioning unit is designed for minimal power consumption. Nevertheless, you should check before taking the system into operation whether the camping site has adequate fuses (minimum 6 A).
- As far as possible, park your vehicle in the shade.
- Darkening the interior with window blinds and / or a roof awning will reduce the penetration of radiant heat.
- Clean the roof of the vehicle regularly (dirty roofs heat up more readily).
- Before operating the device, ventilate your vehicle thoroughly, in order to allow the hot air which builds up inside to escape.
- Take care when putting up awnings or similar that there are sufficient openings for the supply air to be discharged. The opening for the hot discharge air should not be on the intake side.
- To create a healthy environment on the inside of the vehicle, the difference between the inside and outside temperatures should not be selected as too great. During operation the circulated air will be purified and dried. Due to the drying of the moist, humid air, a pleasant environment will be created inside even with slight temperature differences.
- Keep the doors and windows closed while the cooling system is in operation.
- Full fan power at all three openings can only be achieved when three cold air pipes are connected.
- The exhaust duct (part No. 40040-32500) may not be used.
- In heating mode, only set fan to “high” use for heating up quickly. In continuous operation set fan to the “medium” or “low” position.

Before starting to use the device, it is essential that the Operating Instructions and "Safety instructions" be read carefully. The vehicle owner is responsible for ensuring that the device can be operated in the proper manner.

Remote control

i The symbols shown on the display become visible depending on the setting.

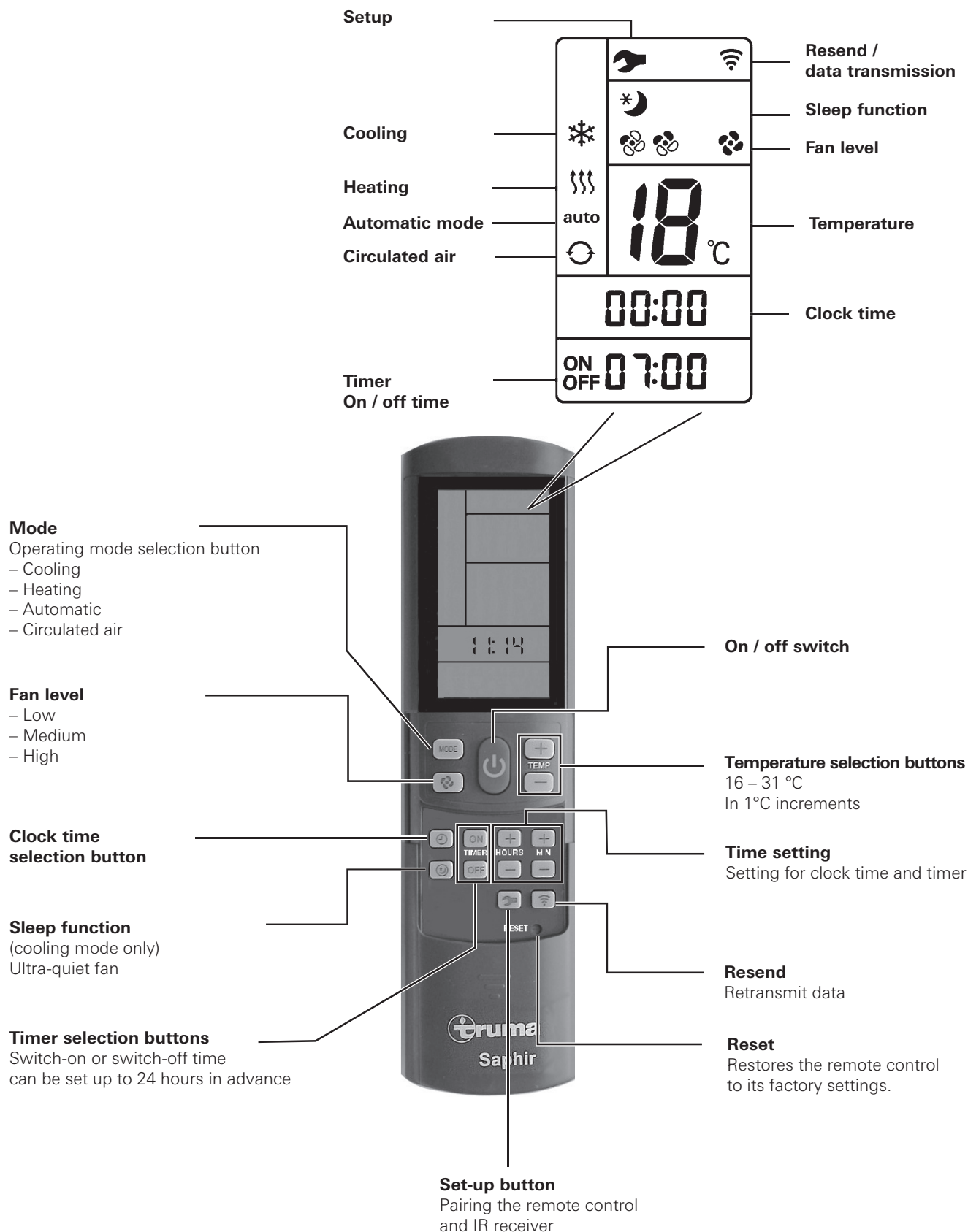

IR receiver and manual on / off

There is an additional pushbutton on the receiver (m), with which the unit can also be switched on and off without the remote control (e.g. with a ballpoint pen).

If the unit is switched on using this pushbutton, the system is automatically reset to the factory settings (Automatic mode, 22 °C).

IR receiver / operating indicator

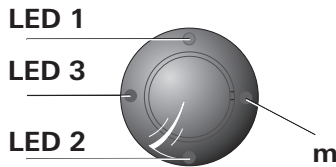

LED 1 blue – permanently on – (cooling mode)
LED 1 blue – flashing – (cooling mode compressor start-up)

LED 2 yellow – permanently on – (heating mode)
LED 2 yellow – flashing – (heating mode compressor start-up)

LED 3 red – flashing – (data is being transmitted)
LED 3 red – permanently on – (fault)

Red LED illuminates

The unit is indicating a fault. Switch unit off, wait for a short time and switch on again. If the red LED continues to illuminate, please contact Domestic Service.

Taking into operation

Before switching on, it is essential to make sure that the fuse system for the power supply at the camp site is sufficient (230 V / minimum 6 A).

 In order to prevent the power cable for the caravan from overheating (minimum cross-section 3 x 2.5 mm²) the cable drum must be fully unwound.

To carry out the individual switching commands, the remote control must always be pointed at the infrared receiver.

Before switching on for the first time, the remote control must be paired with the IR receiver.

- Insert batteries in the remote control (note polarity)
- Symbol flashes
- Press set-up button 2 times and hold
- When the red LED in the IR receiver flashes, release the set-up button
- When the set-up symbol disappears, the remote control is paired with the receiver.

Switching on

Press the **“On / Off switch”** on the remote control to switch on the air conditioning unit. The most recent settings are applied.

 After switching on, the air circulation fan starts to run. The compressor activates after a maximum of 3 minutes, and the blue (cooling) / yellow (heating) LED flashes.

Temperature

If required, adjust the room temperature setting using the **“+”** and **“–” “Temperature selection buttons”**.

Mode

Select the required operating mode by pressing the **“MODE”** button one or more times.

- Cooling
- Heating
- Automatic (heating or cooling mode depending on the room temperature setting)
- Circulated air

When the room temperature that was selected using the remote control is reached in **cooling mode**, the compressor switches off and the blue LED in the IR receiver goes out. The air circulation fan continues to run in order to provide ventilation. If the room temperature setting is exceeded, the device automatically reverts to cooling mode.

When the room temperature that was selected using the remote control is reached in **heating mode**, the compressor switches off and the yellow LED in the IR receiver goes out. The air circulation fan continues to run in order to provide ventilation. If the temperature drops below the room temperature setting, the device automatically reverts to heating mode.

 Heating is not possible where the outside temperature is less than 4 °C. Between 4 °C and 7 °C the device briefly switches to thawing processes. Heating is possible without restrictions above 7 °C.

Cooling/heating mode and the fan level are selected automatically depending on the room temperature when the unit is in **automatic mode**.

In **recirculated air mode**, the interior air is circulated and cleaned by the filters. No LED's illuminate on the IR receiver.

Fan

Select the required fan level by pressing the **“Fan level”** button one or more times.

- **Fan level** (not operational in automatic mode)
- Low
- Medium
- High

Sleep function

When the **“Sleep function”** is active (cooling mode only) the fans operate at slow speed and therefore extremely quietly.

Switching off

Press the **“On / Off”** button on the remote control to switch the equipment off.

 If the air conditioning unit is switched on again, the blue / yellow LED flashes. The air circulation fan runs and the compressor switches itself on after a maximum of 3 minutes.

Time

Press the **“Time selection button”** and set the current time using the **“Time setting”** buttons.

The time is always shown in the display.

The time must be reset after a battery change or daylight saving time change.

Timer ON / OFF

The air conditioning unit on / off time can be set in advance from a minimum of 15 minutes up to a maximum 24 hours, starting from the current time.

To carry out programming, switch on the unit with the remote control.

Set the required operating mode and room temperature.

Then select TIMER ON or TIMER OFF using the **"TIMER selection buttons"**. Set the required on / off time using the **"Time setting"** buttons (15 minutes – 24 hours) and **confirm** with TIMER ON or TIMER OFF.

Press the relevant timer button again to deactivate the timer function.

Reset

Restores the remote control to its factory settings Set-up symbol flashes. The settings on the remote control are reset to "air circulation", fan level low, no timer.

Resend

The most recent settings are transmitted again.

Setup

Press the set-up button until the set-up icon flashes. Air conditioning selection currently in use. Settings are reset to "air circulation", fan level low, no timer.

Maintenance

Located on the front side of the unit is a fluff filter (n) and a particle filter (p) for cleaning the air in the room.

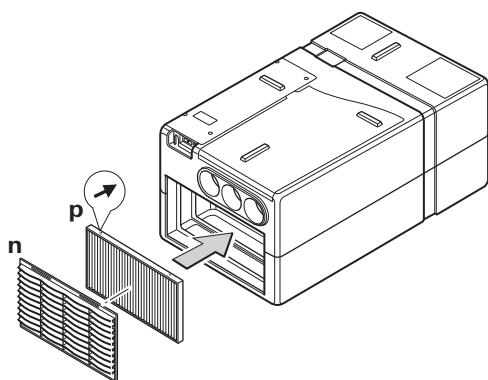

The fluff filter (n) must be cleaned at regular intervals, at least twice a year, and replaced if necessary (part no. 40090-64600).

We recommend that the particle filter (p) be replaced annually at the start of the season (part no. 40090-58100).

To change the filters, disconnect cold air ducts beforehand. Pull fluff filter (n) forward slightly at recesses at upper edge and remove from above. Then withdraw particle filter (p) from the front.

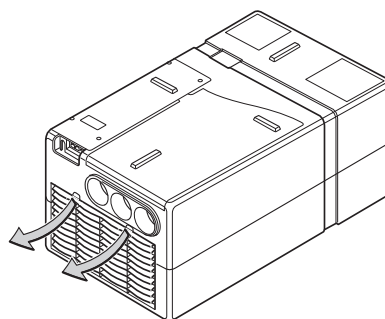

i The arrows printed on the particle filter (p) must point towards the unit when the filter is installed – these indicate the recirculated air flow direction. **The device must never be operated without the filter.** Without a filter the evaporator will become dirty, which in turn will impair the performance of the device!

The condensation water drain is located beneath the floor of the vehicle. In order to allow the condensation to drain away freely, check whether the drain is free of dirt, leaves and the like at regular intervals. **If this is not done, there is a risk of condensation water penetrating into the vehicle!**

Troubleshooting

Is the motor home / caravan 230 V power supply lead connected, and are the fuses and circuit breakers OK?

Fault	Cause / Action
Unit not cooling	<ul style="list-style-type: none">– Defrost in progress / wait until defrosting is completed.– The temperature set on the remote control has been reached / set the temperature on the remote control lower than the room temperature.
Unit not heating	<ul style="list-style-type: none">– Defrost in progress (outside temperature between 4 °C and 7 °C) / set fan lower.– Outside temperature below 4 °C.
Unit cooling insufficiently or not at all	<ul style="list-style-type: none">– Filter dirty / change filter.– External airways dirty, blocked / unblock airways.
Moisture on the cold air pipes	<ul style="list-style-type: none">– High air humidity / close windows and doors and set the fan level to high.
Remote control not working	<ul style="list-style-type: none">– Check remote control batteries / replace batteries if necessary.
Unit not responding to remote control commands	<ul style="list-style-type: none">– Check for obstructions between remote control and IR receiver / remove obstructions if necessary.– Is the remote control paired with the IR receiver / pair remote control to the IR receiver.

If this does not solve the problem, please contact the Dometic Service.

IR remote handset battery change

Please be sure to use leak-proof micro-batteries only, type LR 3, AM4, AAA, MN 2400 (1.5 V).

The battery compartment is located on the rear of the remote control unit.

When fitting new batteries, ensure the polarity (positive / negative) is correct!

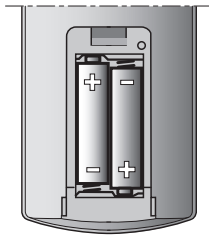

Dead and used batteries may leak and damage the remote control unit. Remove the batteries if the remote control is not going to be used for an extended period.

No claims under guarantee will be considered for damage caused by leaking batteries.

Disposal

Before disposing of a defective remote control, it is essential that the batteries be removed and disposed of in a proper manner.

The device must be disposed of in line with the administrative regulations of the respective country in which it is used. National regulations and laws (in Germany, for example, the End-of-life Vehicle Regulation) must be observed.

Accessories

Noise suppressor for installation in the cold air pipe for additional noise reduction within the living compartment (part no. 40040-60100).

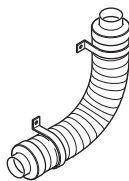

The flexible air conditioning intake allows the air conditioning unit to be installed in a space that is sealed off from the interior (e.g. false floor or rear storage space) and prevents contaminated air from being drawn in (part no. 40090-59100).

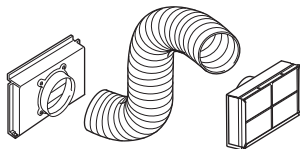

Technical data

Determined on the basis of EN 14511 and the Truma test conditions.

Designation

Saphir compact, comfort air conditioner

Area of operation

Small areas, mobile and stationary

Number of units

1

Dimensions (L x W x H)

628 x 400 x 290 mm

Weight

ca. 23,5 kg

Power supply

230 V – 240 V ~, 50 Hz

Maximum cooling capacity

2,4 kW

Heating power

1,7 kW

Compressor Oil

0,98 kW

Start-up current

20 A (150 ms)

Power consumption

4,2 A

Protection mode

IP X5

Energy Efficiency Rate (EER)

2,4

Volume flow (cold air)

max. 380 m³/h

Cooling agent

R 407C

Cooling agent content

see type plate on the device

Compressor Oil

Diamond MA32, 300 cm³

Noise

depending on installation situation

Maximum inclination of vehicle during operation

5° / 8°

Operational limits

+4 °C to +43 °C

- In cooling mode, a room air sensor prevents the compressor operating under +16 °C.
- An icing sensor prevents impermissible formation of ice on the evaporator.
- A temperature switch prevents excess current flow and excess temperature at the compressor.



Right to effect technical modifications is reserved!

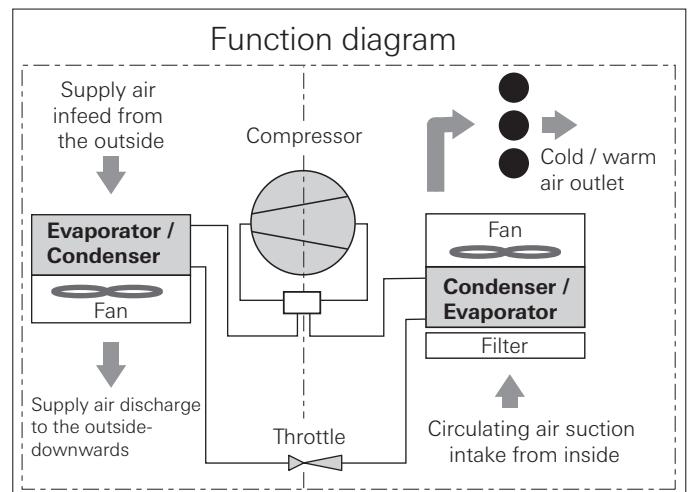

Installation dimensions

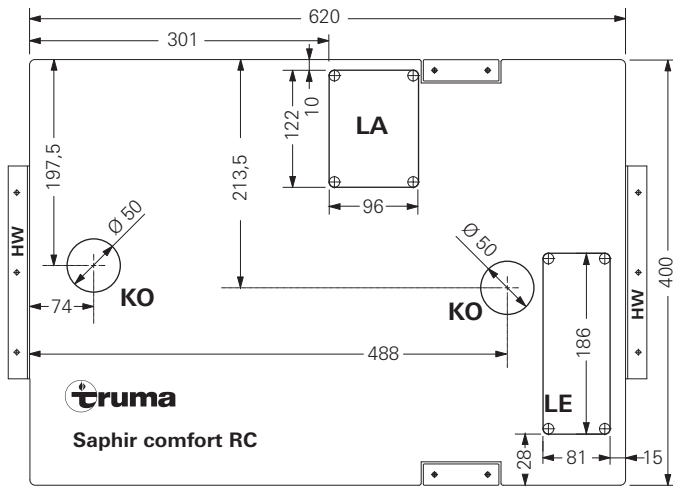

The dimensions are in mm.

Declaration of conformity

1. Information about the manufacturer

Name: Truma Gerätetechnik GmbH & Co. KG
Address: Wernher-von-Braun-Str. 12, D-85640 Putzbrunn

2. Device identification

Type / Model:

Air conditioning unit Saphir comfort RC

3. Meets the requirements of the following EC Directives

- 3.1 Electromagnetic Compatibility 2004/108/EC
- 3.2 Low Voltage Directive 2006/95/EC
- 3.3 Suppression of radio interference of vehicles UN ECE R10
- 3.4 End-Of-Life Vehicle Directive 2000/53/EC

and bears type approval numbers E24 10R-040991 and the CE symbol.

4. Basis of the conformity assessment

72/245/EC, 2009/19/EC, EN55014-1:2006 + A1:2009 (partly);
EN61000-3-2 :2006 + A1 :2009 + A2 :2009; EN61000-3-3:2008;
EN 62233 :2008; EN55014-2 :1997 + A1 :2001 + A2 :2008;
IEC / EN 60335-1; IEC / EN 60335-2-40; DIN EN 378-2

5. Monitoring body

National Standards Authority of Ireland (NSAI)

6. Information and the function of the signatory

Signature: Mathias Venschott
Head of Climate Control
and Manoeuvring Systems
Product Centre

Putzbrunn, 27.11.2012

Truma warranty policy

The warranty is given by Dometic Pty Ltd, Building 3B, Clayton Business Park, 1508 Centre Road, Clayton, Victoria, 3168, for 12 months from the date of purchase against any defect arising from faulty materials or workmanship.

Repairs will be carried out during normal business hours only by Dometic Pty Ltd, or its duly authorised service agents, and are subject to the warranty conditions and exclusions hereunder.

Warranty conditions

- The company will only provide service on presentation of proof of purchase, on either the Truma product, or the Caravan / RV / Pleasure Craft in which the Truma product has been installed, to any authorised service agent. The purchaser must allow the service agent to photocopy the proof of purchase to facilitate his claim to the manufacturer.
- Warranty repairs can only be performed by authorised service agents and under no circumstances will Dometic reimburse repairs carried out by unauthorised persons. Tampering with any part of the product by unauthorised personnel will automatically void the warranty.
- The product must be used solely for domestic purposes only. If the product is used for commercial purposes the warranty is 6 months only.
- Where applicable, the products must be used on the appropriate electrical voltage, gas type and pressure, or fuel source.
- If at any time during the warranty period any part or parts are replaced with a part or parts not supplied or approved by Truma, this warranty shall immediately become void.

Important notice

Before calling a service technician please check carefully the operating instructions, service booklet and warranty terms and conditions. If the product fails for any of the reasons detailed therein, or is faulty due to abuse, misuse or improper installation, then a service fee shall be charged to the purchaser.

If you have any queries regarding the interpretation of the warranty you should contact Dometic Pty Ltd.

Whilst this book represents service outlets at the time of printing, changes occur from time to time. Should you have any queries or wish to locate your nearest authorised service agent please contact Dometic Pty Ltd.

Warranty does not cover

- Any appliance which has been:
 - (a) Subject to misuse, neglect, accident or alteration by any person.
 - (b) Damaged or destroyed by fire, flood, act of God or other inevitable accident.
- Fair wear and tear.
- Damage from foreign substances such as dirt or liquid.
- Travelling expenses or call out fee to and from authorised service agents premises.
- Accommodation or Site Expenses.
- Cleaning of the system. This is considered to be a part of normal product maintenance.
- Non operation of the appliance or resultant damage to the unit where the appliance has been operated in an out of level situation.
- Freight cost of the appliance or parts, to or from, point of service or transit damage.
- Dometic / Truma are not responsible for resultant loss or damage sustained by the purchaser.
- Non operation of the appliance or resultant damage to the unit where the appliance has not been installed, ventilated, flued or operated in accordance with the manufacturers instructions.

Apart from any warranties implied by the Trade Practices Act 1974 or any relevant State legislation all other warranties express or implied whether arising by virtue of statute or otherwise are hereby excluded.

Installation instructions



Installation and repair of the device may only be carried out by properly qualified professionals. Before starting work, read the installation instructions thoroughly and follow them carefully!

Scope of delivery

- 1 Saphir comfort RC
- 1 remote control with batteries
- 1 IR receiver
- 4 mounting brackets with screws, 1 strap
- 2 condensate drains
- 2 floor grids
- 1 installation template
- 1 operating instructions / installation instructions

Intended use

This unit was designed for installing in motor homes and caravans. It is intended for domestic use.

Regulations

Guarantee claims, warranty claims and acceptance of liability will be ruled out in the event of the following:

- modifications to the unit (including accessories),
- failure to use original Truma parts as replacement parts and accessories,
- failure to follow the installation and operating instructions.

Choice of location

The device is in principle to be installed in such a way that it is readily accessible at all times for servicing work, and can be easily removed and installed.

i In installation situations where space is restricted, the 2 connecting cables (power cable and IR receiver cable) must be long enough for the system to be withdrawn with the cables attached and the cover opened.

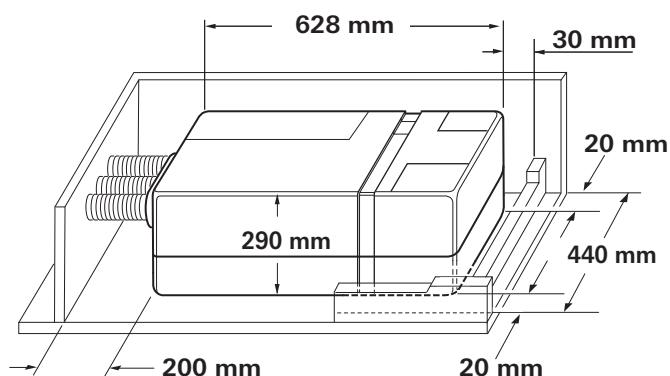

i In order to achieve homogeneous vehicle cooling, the air conditioning unit must be installed **in a central location** in a false floor or the like so that the cold air is evenly distributed.

The air conditioning unit is attached to the floor, which must be level and smooth. If necessary, in, for example, uneven ground, the air inlet (LE), air outlet (LA) and connectors (11) can be fitted with additional seals.

The air that is to be cooled is drawn in again by the unit from the vehicle interior through openings with a total area of at least 300 cm².

! The circulated air will be purified and dried while the unit is in operation. Accordingly, if the unit is installed in external stowage containers (e.g. double bottoms) suitable steps must be taken to ensure that the air which is to be cooled is extracted from the interior of the vehicle. The suction intake of air from the outside can severely impair the effect of the air conditioning system.

If possible, position the unit so that the frame of the vehicle is between the air inlet (LE) and the air outlet (LA).

Place the installation template into the stowage box that is intended for installation and check the space situation for the floor openings. The air conditioning unit should have at least 20 mm of clearance at the sides and 30 mm at the rear from walls and any furniture items in order to prevent noise transmission during operation. The minimum clearance at the front is 200 mm, so that the fluff / particle filter can be changed.

! The openings in the floor of the vehicle must be freely accessible, and must not be blocked by frame sections behind them or the like! The openings must not be within the range of the wheel spray. Spray guards must be fitted if necessary.

Installing the air conditioning system

Place installation template in stowage compartment and fix in position.

Mark fastening holes for the 2 retaining brackets (2 – HW) and the 2 fastening brackets (3) at the sides.

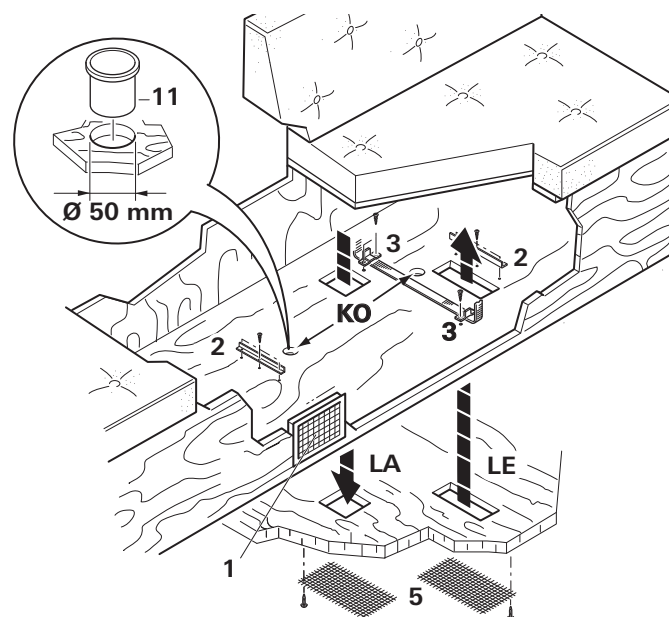

Mark the lower opening "LE" for feeding in air, "LA" for extracting air and "KO" for the condensate drainage.

Remove template and cut out the marked floor openings.

Before drilling, always check for underlying / concealed cables, gas lines, frame sections and the like!

Then seal the edges of the openings in the floor of the vehicle with underfloor protection.

Screw down each of the 2 side fastening brackets (3) with 2 screws and each of the 2 retaining brackets (2 – HW – leg must be on the outside!) with 3 screws.

Insert the connectors (11) for draining condensate (KO) from above.

Seal the circumference of connectors (11) for draining condensate from below with automotive body sealant.

i When installing the unit, it is vital to ensure that the connectors (11) to the condensate drainage are located in the recess at the bottom of the device. Otherwise there is a risk of water penetrating the interior! In order to provide good air circulation, the openings in the bottom of the unit and the floor must align exactly. Correct operation of the unit cannot be guaranteed unless this is the case!

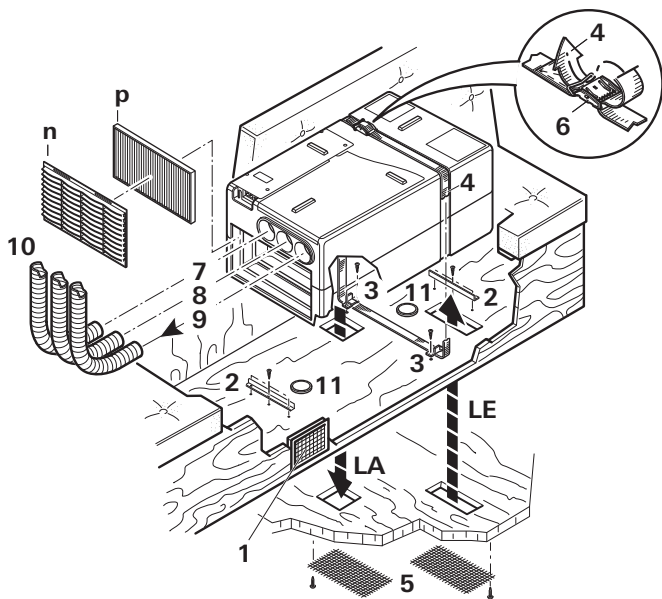

Guide the tension strap (4) through the 2 fastening brackets (3) – the lettering on the tension strap should face downwards.

Place air conditioning unit in the stowage compartment between the retaining brackets (2 – HW) and the fastening brackets (3). Secure air conditioning unit using the tension strap (4). Ensure that the tension strap is inserted in the recesses provided on the unit. Guide tension strap (4) through the clasp (6) as shown in the illustration and tighten.

! The air conditioning unit must be attached **at all sides** using the brackets provided in order to prevent unintentional movement if vigorous movements occur (e.g. hard braking).

Attach the two floor grilles (5) for “LE” and “LA” to the floor of the vehicle from below with suitable screws or clips (not provided).

Cold air distribution and circulating air return feed

Air distribution

i The same pipework (cold air pipes) are used in heating / cooling mode.

A KR 65 Ø 65 mm (10) cold air duct with at least one outlet must be connected to each of the three cold air emitters of the unit (7, 8 and 9).

Slide the cold air ducts (10) into the cold air outlets of the unit and route to the air outlet nozzles. Ensure that the cold air ducts are firmly seated in the cold air outlets. Truma can supply a sound muffler for installing in the cold air system (part no. 40040-60100) as an accessory for reducing the noise level.

Suitable vents for air in the passenger compartment are the SCW 2 swivelling nozzles (black – part no. 39971-01 or beige, part no. 39971-02), end piece EN-O (part no. 40171-07) with lamella inset LA (part no. 40721-01/02/03/04/05) or the RL rectangular air outlet (part no. 40280-01) with the ANH connecting piece (part no. 40290-02) have proven to be suitable for emitting the cooled air into the interior of the vehicle.

Important notes

The cold air distribution system is individually designed for each vehicle model using a modular principle. A wide range of accessories is available for this purpose.

In order to achieve the best possible cooling power, we recommend:

- Route cold air pipes to air vents as short and straight as possible.
- The total accumulated length of cold air duct that may be used is 15 m.
- Connect the longest cold air pipe (max. 8 m) to the right-hand cold air outlet (9), since this has the most air throughput.
- To prevent condensation in the cold air ducts, do not route pipes anywhere near heat sources (e.g. power supplies or behind the refrigerator).

Circulating air return

The circulating air is drawn in again by the unit, either through an additional rectangular air grille (1 – part no. 40040-29200) or 3 round air grilles (part no. 40040-20400), e.g. in the stowage box wall or via several smaller openings with a total area of at least 300 cm².

Important note

To ensure trouble-free air exchange, the air infeed from the interior of the vehicle to the installation location must be located in the immediate vicinity of the device. If appropriate, covers are to be fitted, in order to avoid the circulating air return being impeded by stowed objects.

i If the equipment cannot be installed in close proximity, Truma can provide a flexible air intake (part no. 40090-59100) as an accessory.

Installing the IR receiver

The receiver (12) is to be fitted for preference on the clothes cabinet in such a way that the remote control can be pointed at it without any hinderance (length of connection cable 3 m). If necessary, a 3 metre cable extension can be supplied (part no. 40090-89100).

i If the receiver cannot be flush-mounted, Truma can provide an on-surface frame (13) – part no. 40000-52600 as an accessory if required.

Drill Ø 55 mm hole. Lead IR receiver cable (17) through towards the rear and secure receiver with 4 screws (14 – not provided). Then clip on the cover frame (15) and route cable (17) to air conditioning unit.

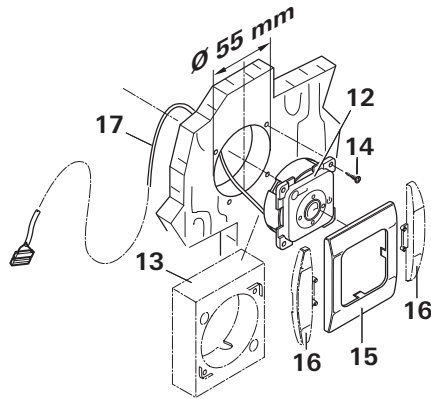

i Truma will supply side parts (16) in 8 different colours for finishing off the cover frames (please contact your dealer for details).

230 V electrical connection and IR receiver connection

! The 230 V electrical connection must always be made by an expert (in accordance with VDE 0100, part 721 or IEC 60364-7-721, for example, in Germany). The instructions given here are not a challenge to the lay person to carry out the electrical connection, but serve to provide additional information for the professional fitter whom you engage!

Establish the connection to the mains with the connection cable (20), 150 cm long, to a lead in the vehicle, fused to at least 10 A.

It is essential to ensure the correct cable colours are connected!

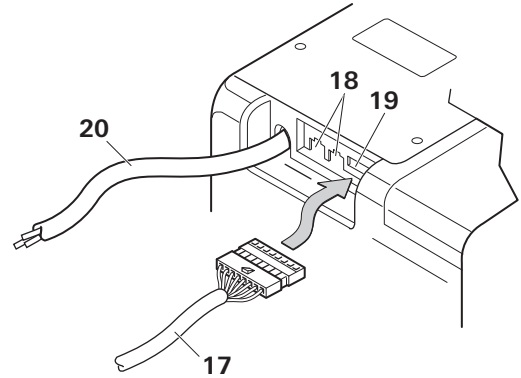

Insert plug of IR receiver cable (17) into socket (19).

i The port (18) is a com port for communication and is not required for operating the equipment.

The cables must be long enough for the unit to be pulled out of the false floor with the cables attached. All cables must be secured with cable clips!

For maintenance or repair work, an isolating device must be provided on the vehicle side to provide all-pole isolation from the mains, with a contact interval of at least 3.5 mm.

Function test / Mounting for the remote control

Position IR remote handset cradle as close as possible to the IR receiver (12) so that the air conditioning unit can be operated without removing the remote handset from the cradle.

In conclusion, all the functions of the device need to be tested in accordance with the Operating Instructions.

The operating instructions must be handed to the owner of the vehicle.



In Australia, always notify the Dometic Service Centre if problems are encountered; in other countries the relevant service partners should be contacted (see Service Booklet or www.truma.com).

Having the equipment model and the serial number ready (see type plate) will speed up processing.

Service (Australia)

Telephone: +61 (0)3 92 39 10 00
Facsimile: +61 (0)3 92 39 10 99

Service (New Zealand)

Telephone +64 (0)4 232 38 98
Facsimile +64 (0)4 232 38 78